

DELTA®

DELTA® protects property. Saves energy. Creates comfort.

DÖRKEN

DELTA®-MS

**High compressive strength
for extra safety.**

Low point loads.

Fast, tailored application straight from the roll on perimeter insulation, sealing slurries, and waterproof concrete.



■ Protection system

■ For building, underground, and civil-engineering construction

■ For vertical and horizontal application

STANDARD QUALITY

**One dimpled sheet
for three end uses?
You cannot go wrong
with DELTA®!**



■ **DELTA®-MS**

The right solution is always within reach: With its excellent track record, this dimpled sheet offers outstanding safety in building, underground, and civil-engineering construction. It may be used

- as a sub-base course under concrete floor slabs,
- for foundation-wall protection, and
- as a seepage layer in cavity walls.

Installation is swift and easy: The time for laying a square metre straight from the roll is less than four minutes.

■ **DELTA®-Accessories**

Why not use the advantages of our comprehensive range of DELTA® Accessories:

- DELTA®-NOPPENBAHNEN-PROFIL,
- DELTA®-HAFTNAGEL,
- DELTA®-MS DÜBEL,
- DELTA®-MS KNOPF.

DELTA® quality branded products made by Dörken.

Reliable long-term protection:

DELTA®-MS

High dimple density. Heat insu

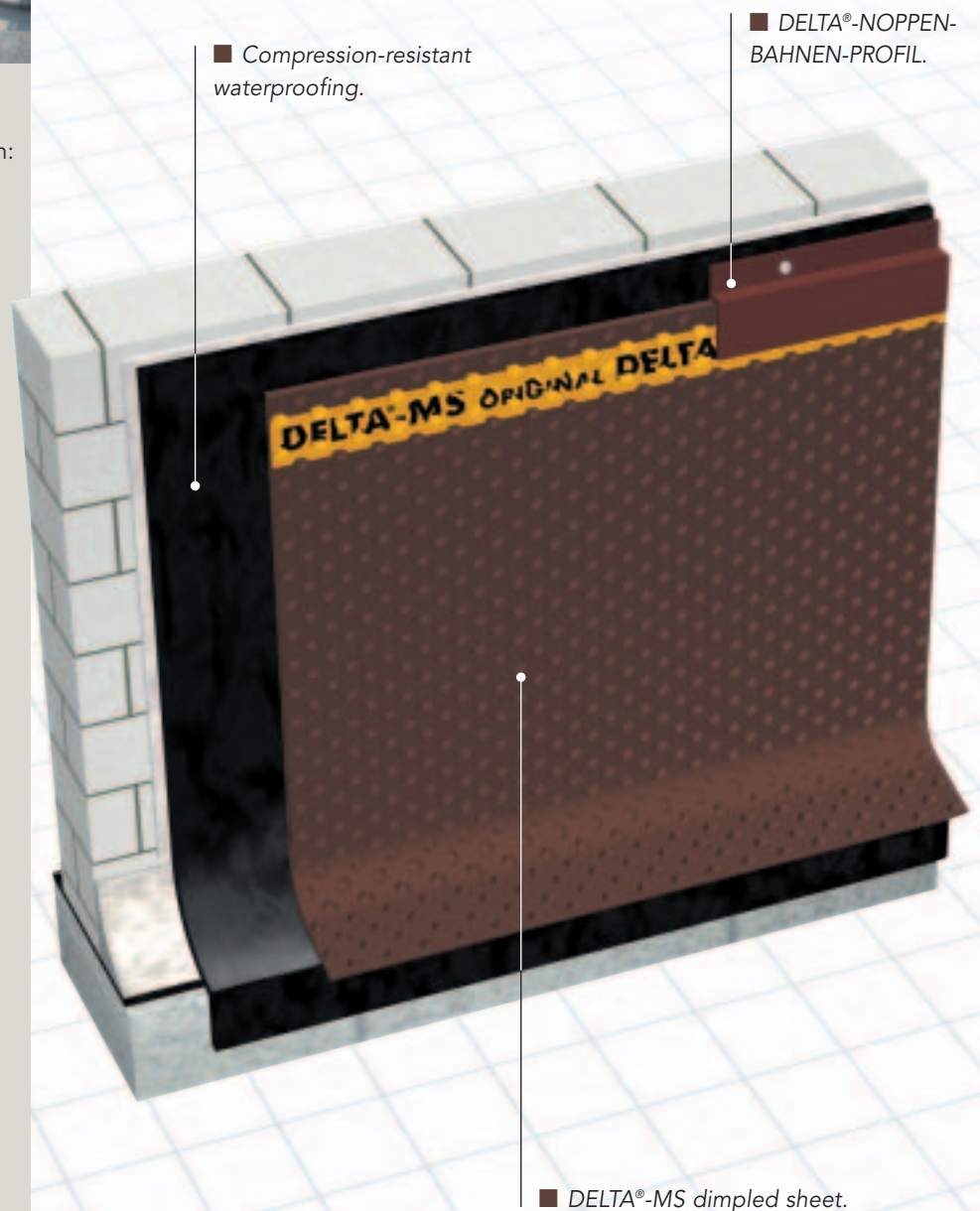

■ Compression-resistant waterproofing.

■ DELTA®-NOPPENBAHNEN-PROFIL.

■ DELTA®-MS dimpled sheet.



DELTA®-NOPPENBAHNEN-PROFIL moulding cap.

Reliable sub-base course under floor slabs.

Efficient structural drainage in tunnels.

lation. No degradation in soil.

DELTA®-MS ...

- ... is a dimpled sheet made of special high-density polyethylene.
- ... features more than 1800 dimples per m² for efficient pressure distribution and low point loads even on perimeter insulation.
- ... has a high compressive strength of about 250 kN/m².
- ... is non-polluting for drinking water, non-degradable in soil, and offers additional heat insulation.
- ... features flat overlapping edges for precisely-fitting joints and a diagonal dimple configuration to permit straight creases.
- ... safely separates foundation walls from moist soil for all-round protection of compression-resistant waterproofing coats and/or perimeter insulation.
- ... protects flooring from rising damp.
- ... offers a cost-efficient alternative to lean concrete when laid underneath floor slabs as a sub-base course.



Easy to install, DELTA®-MS safely protects foundation walls.



Why not profit from the DELTA® System?

DELTA® foundation protection and DELTA® drainage systems.

	On compression-resistant waterproofing (e. g. bitumen, sealing slurries), perimeter insulation, and waterproof concrete	On compression-sensitive waterproofing (e. g. elastic bituminous waterproofing coats)
Structural drainage not required	DELTA®-MS foundation-wall protection	DELTA®-GEO-DRAIN Quattro foundation-wall protection as per DIN 18195
Structural drainage required	DELTA®-TERRAXX foundation-wall protection as per DIN 18195, structural drainage as per DIN 4095	DELTA®-GEO-DRAIN Quattro foundation-wall protection as per DIN 18195, structural drainage as per DIN 4095

DELTA®-MS

Technical Data Overview:

Dimpled sheet material	HDPE No plasticizer; fully recyclable.
Dimple height	approx. 8 mm
Compressive strength	approx. 250 kN/m ²
Air gap between dimples	approx. 5.3 l/m ²
Service temperature range	-30 °C to +80 °C
Fire resistance	Optional conformability with DIN 4102 Class B 2 or Class B 1 to meet special requirements.
Roll sizes	20 m x 1.0 m 20 m x 1.5 m 20 m x 2.0 m 20 m x 2.4 m 20 m x 3.0 m

DELTA®-Accessories for DELTA®-MS.

Dörken makes your life easier – systematically.

You are sure to appreciate these handy DELTA®-Accessories:



DELTA®-NOPPEN-BAHNEN-PROFIL
Edge sealing strip.

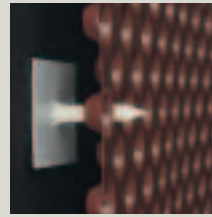

DELTA®-HAFTNAGEL
Self-adhesive pin aids installation.

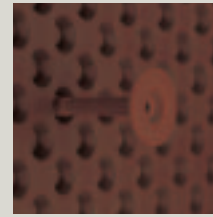

DELTA®-MS DÜBEL
Plastic wall plug for sheet attachment.

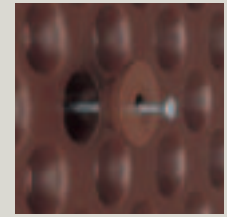

DELTA®-MS KNOPF
Washer which keeps the material from tearing during attachment.

DELTA® is a registered trademark of Ewald Dörken AG, Herdecke, Germany.

DELTA®



DELTA® System ...

... for owners:

" ... What I get is a mature problem solution provided at a fair price by the top specialist in quality branded products!"

... for workers:

" ... What I get is a complete system made by a single manufacturer that enables me to do anything to the owner's entire satisfaction. There is no safer way!"

... for planners:

" ... I can be certain that both innovative and standard products will be used in implementing my roof and cellar plans in a systematic and forward-looking way."



Dörken GmbH & Co. KG
Wetterstraße 58
D-58313 Herdecke
Tel.: +49 23 30/63-0
Fax: +49 23 30/63-355
bvf@doerken.de
www.doerken.de

A company of the Dörken Group.

■ **Standard requests for tender and detailed installation instructions** for all DELTA® products may be obtained from www.doerken.de as PDF files for you to print out and save.